

QHC9-2000-8000-60

2~8GHz, 60W

Features:

- * Broadband
- * High Power
- * Low Insertion Loss

Applications:

- * Amplifiers
- * Transmitter
- * Laboratory Test
- * Radar

Electrical

Frequency:	2~8GHz
Insertion Loss:	0.8dB max.
Isolation:	17dB min.
VSWR:	1.5 max.
Amplitude Balance:	±1dB
Phase Balance:	±8°
Average Power:	60W max.
Impedance:	50Ω

Mechanical

Size ^{*1} :	60*25*11mm 2.362*0.984*0.433in
Port Connectors:	Pin (Φ0.5*2mm)
Mounting:	4-Φ2.3mm through-hole

[1] Exclude connectors.

Environmental

Operating Temperature:	-30~+70°C
Non-operating Temperature:	-40~+80°C

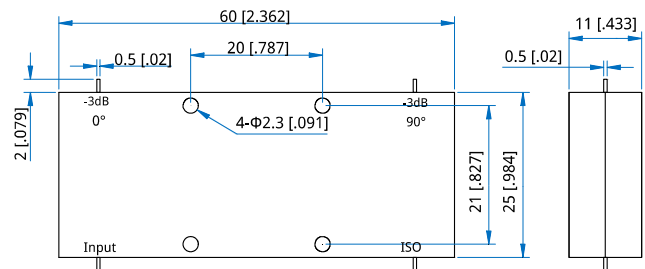
Outline Drawings

Unit: mm [in]

Tolerance: ±0.2mm [±0.008in]

How To Order

QHC9-2000-8000-60

Customization is available upon request.